

177 BERRIMA RD, MOSS VALE

DEVELOPMENT APPLICATION

DWG NO	DRAWING TITLE	SCALE
LA01	COVER SHEET	N/A
LA02	LANDSCAPE PLAN	1:250
LA04	PLANTING CHARACTER	N/A
LA05	LANDSCAPE DETAILS	As shown





OVERHEAD ELECTRICAL LINE

BERRIMA ROAD

BOWMAN ROAD

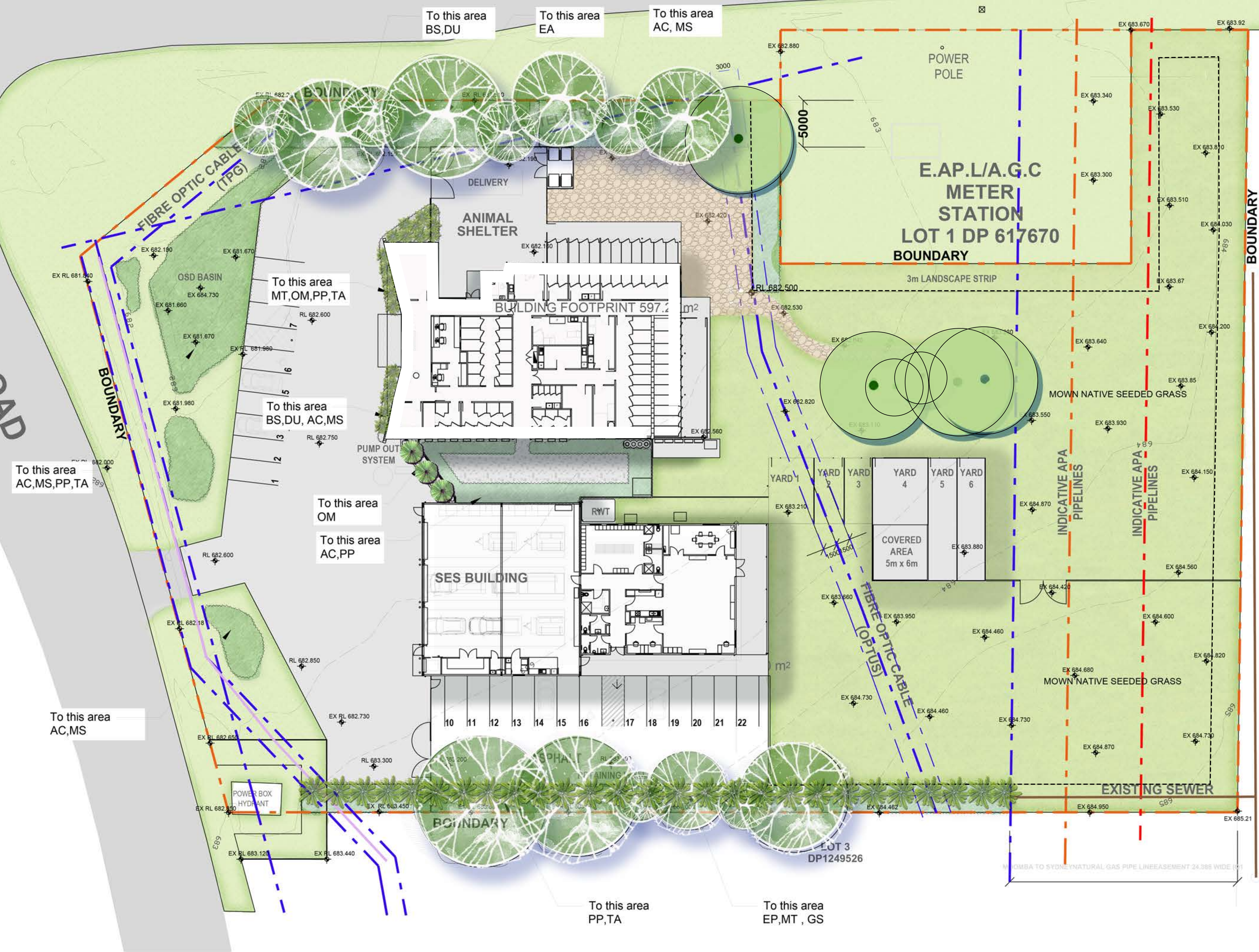

LOT 6  
DP1249526

WINGECARRIBEE  
COMMUNITY  
RECYCLING  
CENTRE

# LANDSCAPE PLAN

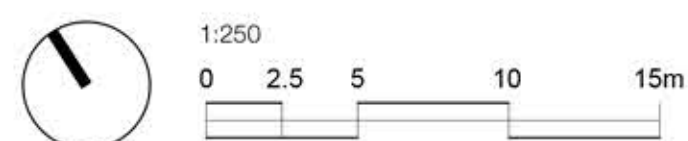

## LEGEND



project: Wingecarribee Animal Shelter and SES  
client: Figgis Jefferson Tapa  
date: 27.05.2022  
revision: C  
drawn: RS  
checked: AL

**TaylorBrammer**  
TAYLOR BRAMMER LANDSCAPE ARCHITECTS PTY LTD  
SYDNEY STUDIO  
215 Oxford Street Woolahra, NSW, 2025 E: sydney@taylorbrammer.com.au T: 61 2 9387 8855  
Copyright of Taylor Brammer Landscape Architects Pty Ltd. ABN 61 098 724 988



# TREES



Eucalyptus pauciflora Snow gum



Eucalyptus pauciflora Snow gum



Eucalyptus amplifolia Cabbage gum



Eucalyptus amplifolia Cabbage gum

# SHRUBS



Daviesia ulicifolia Bitter pea



Daviesia ulicifolia Bitter pea



Melaleuca thymifolia Honey myrtle



Melaleuca thymifolia Honey myrtle

# GROUND COVERS



Dianella caerulea Wandering lily



Austrodanthoia caespitosa Wallaby grass



Microlaena stipoides Weeping grass



Themeda australis Kangaroo grass

## PLANT SCHEDULE

ID	BOTANICAL NAME	COMMON NAME	HEIGHT (m)	POT SIZE	QTY
<b>TREES</b>					
EA	<i>Eucalyptus amplifolia</i>	Cabbage gum	20	300mm	8
EP	<i>Eucalyptus pauciflora</i>	Snow gum	12	300mm	6
<b>SHRUBS</b>					
BS	<i>Banksia spinulosa</i>	Hairpin banksia	2	140mm	24
DU	<i>Daviesia ulicifolia</i>	Bitter pea	1	140mm	24
MT	<i>Melaleuca thymifolia</i>	Honey myrtle	1	140mm	24
OM	<i>Olearia microphylla</i>	Small leafed daisy bush	1	140mm	25
<b>GROUNDCOVERS</b>					
AC	<i>Austrodanthoia caespitosa</i>	Wallaby grass	0.5	Tube	852
MS	<i>Microlaena stipoides</i>	Weeping grass	0.6	Tube	852
PP	<i>Pandorea pandorana</i>	Wonga Wonga vine	-	Tube	852
TA	<i>Themeda australis</i>	Kangaroo grass	1	Tube	852

Note, the above species are representative of the EEC Southern Highlands Shale Forest vegetation community as identified by NSW OEH

# PLANTING CHARACTER



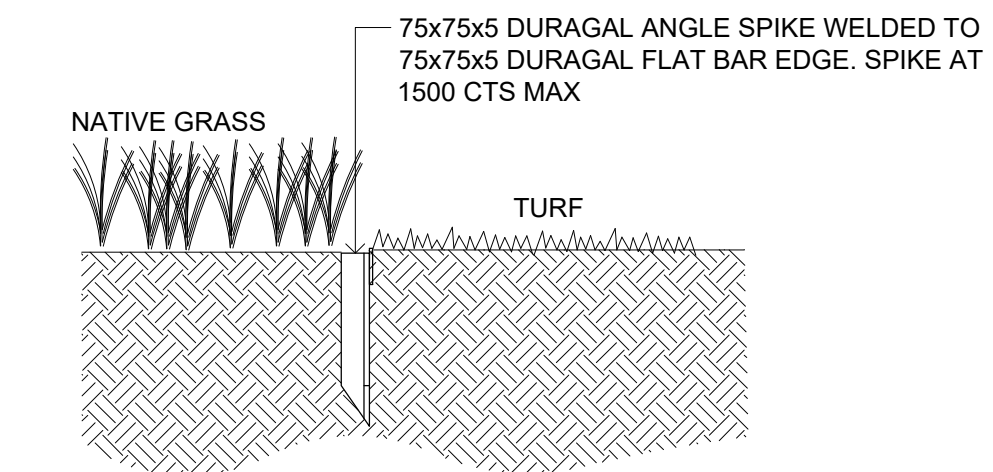
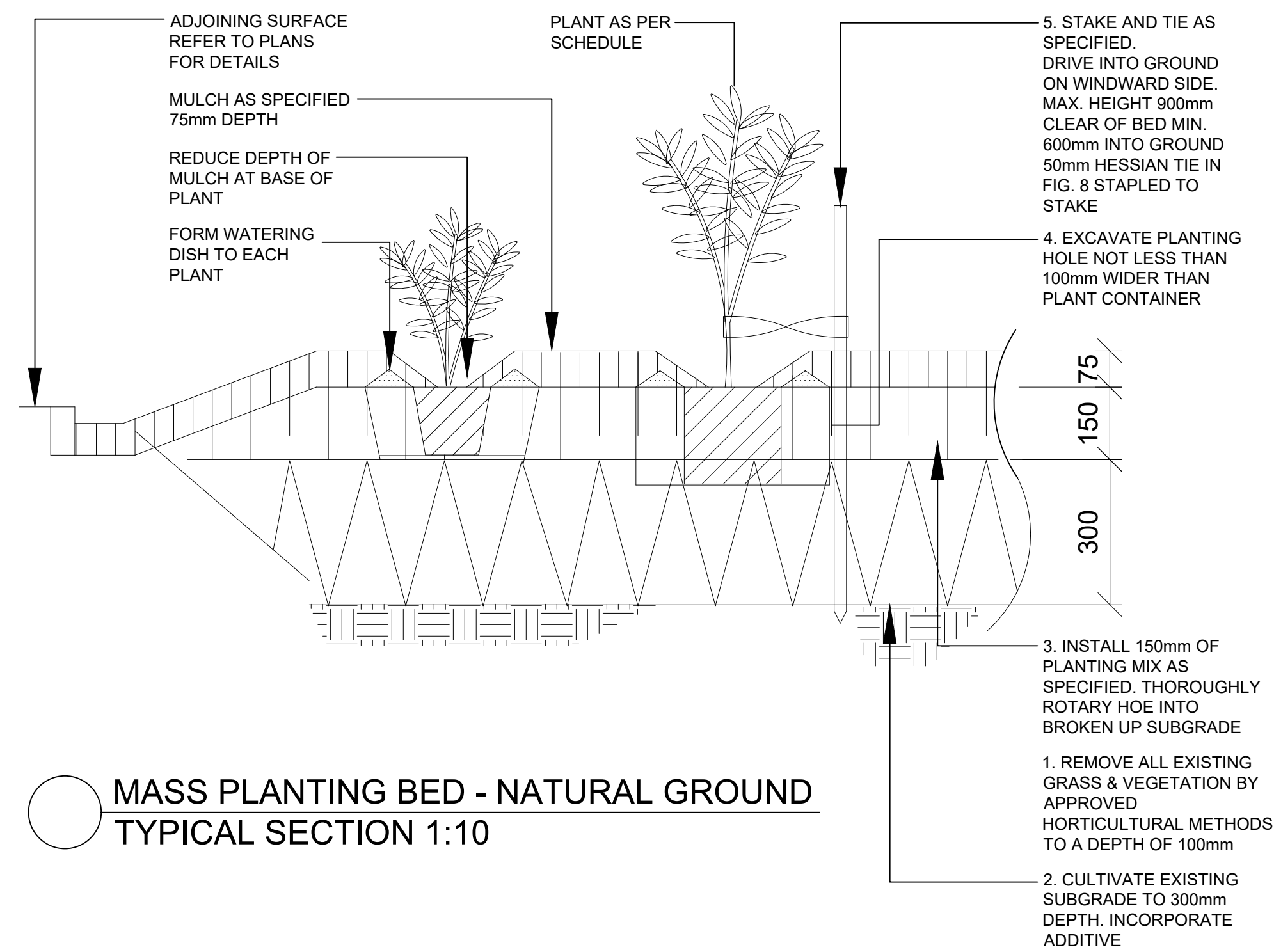

**STEEL EDGE**  
TYPICAL SECTION 1:20

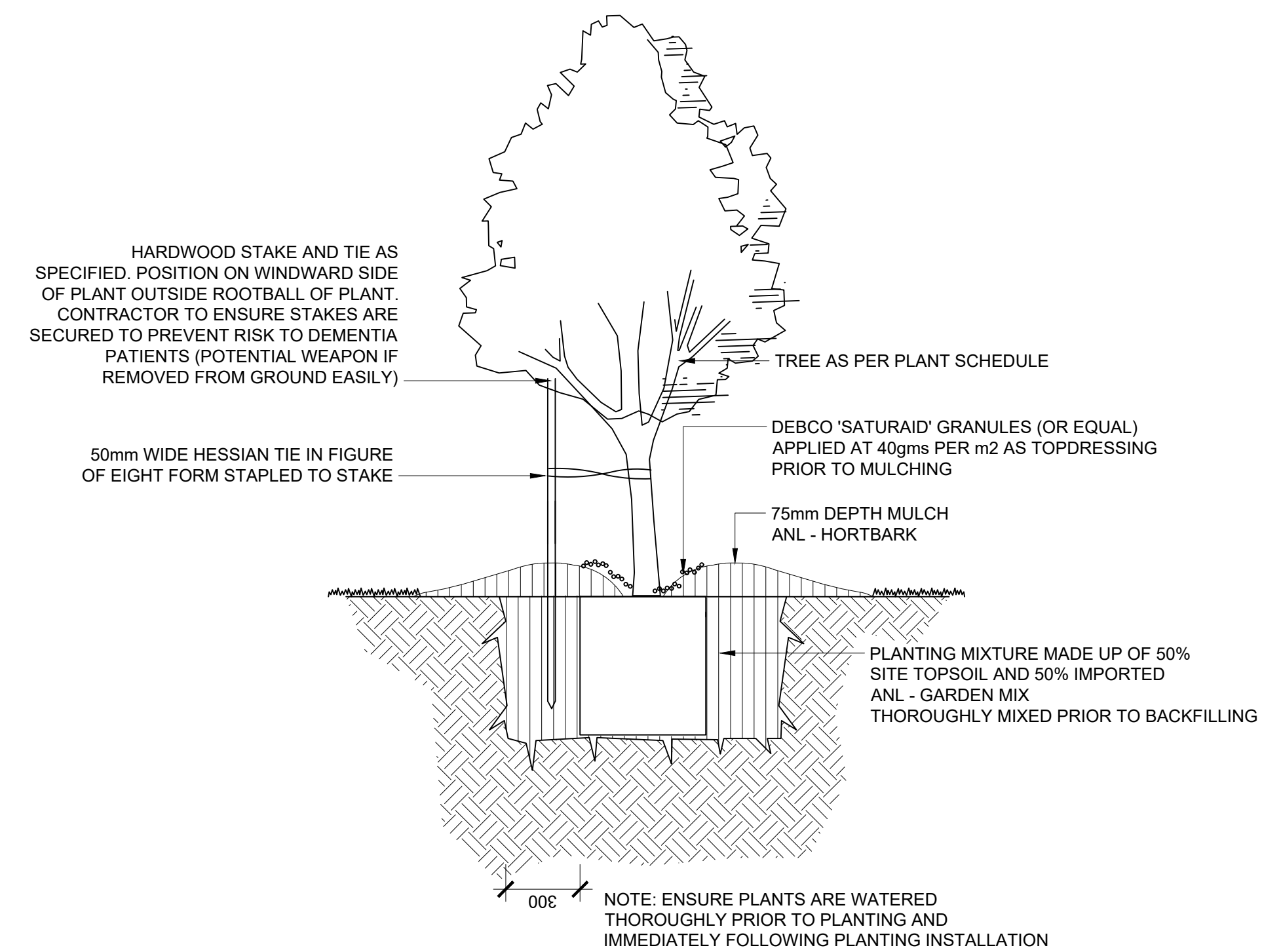
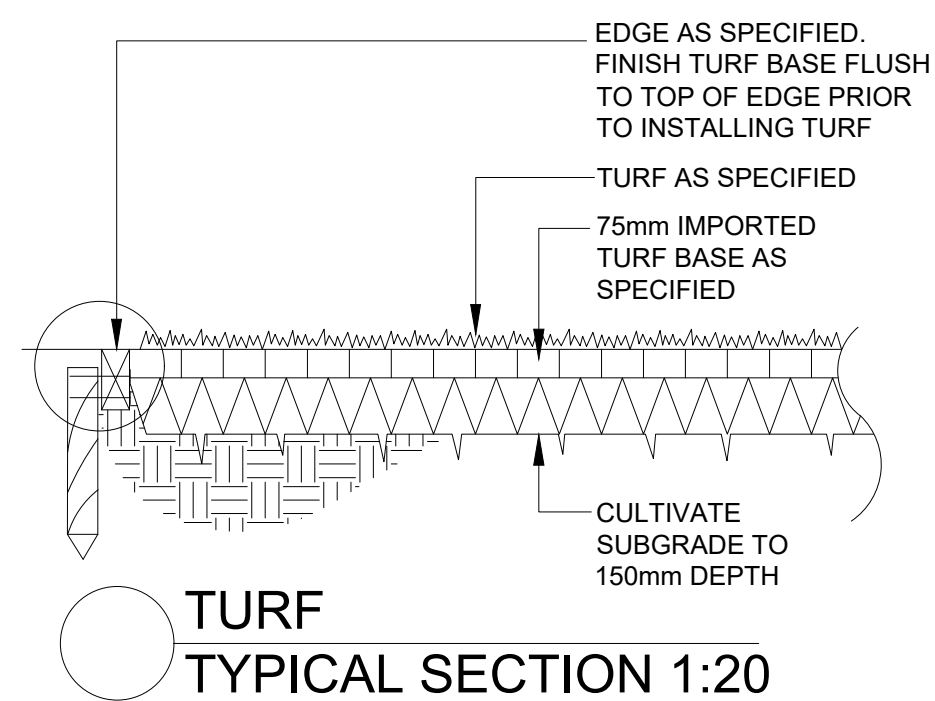

**TREE PLANTING**  
TYPICAL SECTION 1:20

# LANDSCAPE DETAILS

**project:** Wingecarribee Animal Shelter and SES  
**client:** Figgis Jefferson Tepa  
**date:** 20.05.2022  
**revision:** B  
**drawn:** RS  
**checked:** AL

**TaylorBrammer**  
TAYLOR BRAMMER LANDSCAPE ARCHITECTS PTY LTD  
SYDNEY STUDIO  
218 Oxford Street Woolahra, NSW, 2025 E sydney@taylorbrammer.com.au T 61 2 9387 8855  
Copyright of Taylor Brammer Landscape Architects Pty Ltd. ABN 61 098 724 988

# 177 BERRIMA RD, MOSS VALE

## TENDER DOCUMENTATION

DWG NO	DRAWING TITLE	SCALE
LA01	COVER PAGE	N/A
LA02	HARDWORKS PLAN	1:250
LA04	PLANTING PLAN	1:250
LA05	LANDSCAPE DETAILS	As shown







PLANT SCHEDULE

ID	BOTANICAL NAME	COMMON NAME	HEIGHT (m)	POT SIZE	QTY
<strong>TREES</strong>					
EA	<i>Eucalyptus amplifolia</i>	Cabbage gum	20	300mm	7
EP	<i>Eucalyptus pauciflora</i>	Snow gum	12	300mm	6
<strong>SHRUBS</strong>					
BS	<i>Banksia spinulosa</i>	Hairpin banksia	2	140mm	15
DU	<i>Daviesia ulicifolia</i>	Bitter pea	1	140mm	16
MT	<i>Melaleuca thymifolia</i>	Honey myrtle	1	140mm	18
OM	<i>Oleaia microphylla</i>	Small leaved daisy bush	1	140mm	17
JM	<i>Juncus kraussii</i>	Matting rush	1	140mm	227
IN	<i>Isolepis nodosa</i>	Knobby Club Rush	1	140mm	319
LL	<i>Lomandra longifolia</i>	basket grass	1	140mm	227
<strong>GROUNDCOVERS</strong>					
AC	<i>Austrodanthonia caespitosa</i>	Wallaby grass	0.5	Tube	375
MS	<i>Microlaena stipoides</i>	Weeping grass	0.6	Tube	203
PP		Wonga Wonga vine	-	Tube	208
TA	<i>Themeda australis</i>	Kangaroo grass	1	Tube	290

Note, the above species are representative of the EEC Southern Highlands Shale Forest vegetation community as identified by NSW OEH

TaylorBrammer



TAYLOR BRAMMER LANDSCAPE ARCHITECTS PTY LTD  
SYDNEY STUDIO  
218 Oxford Street  
Woolahra, NSW, 2025  
T 61 2 9387 8855  
F 61 2 9387 8155  
E sydney@taylorbrammer.com.au

LEGEND

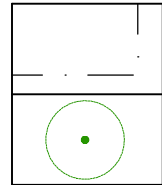

SITE BOUNDARY

EXISTING TREE  
RETAINED

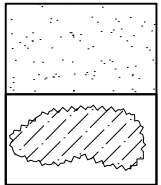

TURF

PROPOSED  
GROUNDCOVERS

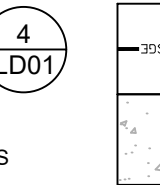

STEEL GARDEN EDGE

CONCRETE PAVING

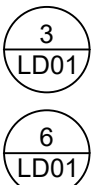

PROPOSED SHRUBS

PROPOSED TREE

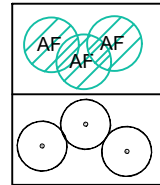

PROPOSED SHRUBS

PROPOSED TREE

C	TENDER ISSUE	15.06.2023
B	TENDER ISSUE	05.12.2022
A	TENDER ISSUE	25.10.2022
P1	TENDER ISSUE	10.10.2022
ISSUE	DESCRIPTION	DATE

PROJECT:  
WINGECARRIBEE ANIMAL SHELTER AND SES

DRAWING TITLE:  
PLANTING PLAN

CLIENT:  
FIGGIS JEFFERSON TEPA

0 2.5 5 10 15m

SCALE: 1:250 @ A1  
CREATED: 15.06.2022  
DRAWN: RS  
CHECKED: AL  
JOB NO: 22-006a  
DESIGNED: AL  
DRAWING NO: LA03  
REVISION: C

Copyright of Taylor Brammer Landscape Architects Pty Ltd.  
ABN 61 088 724 988



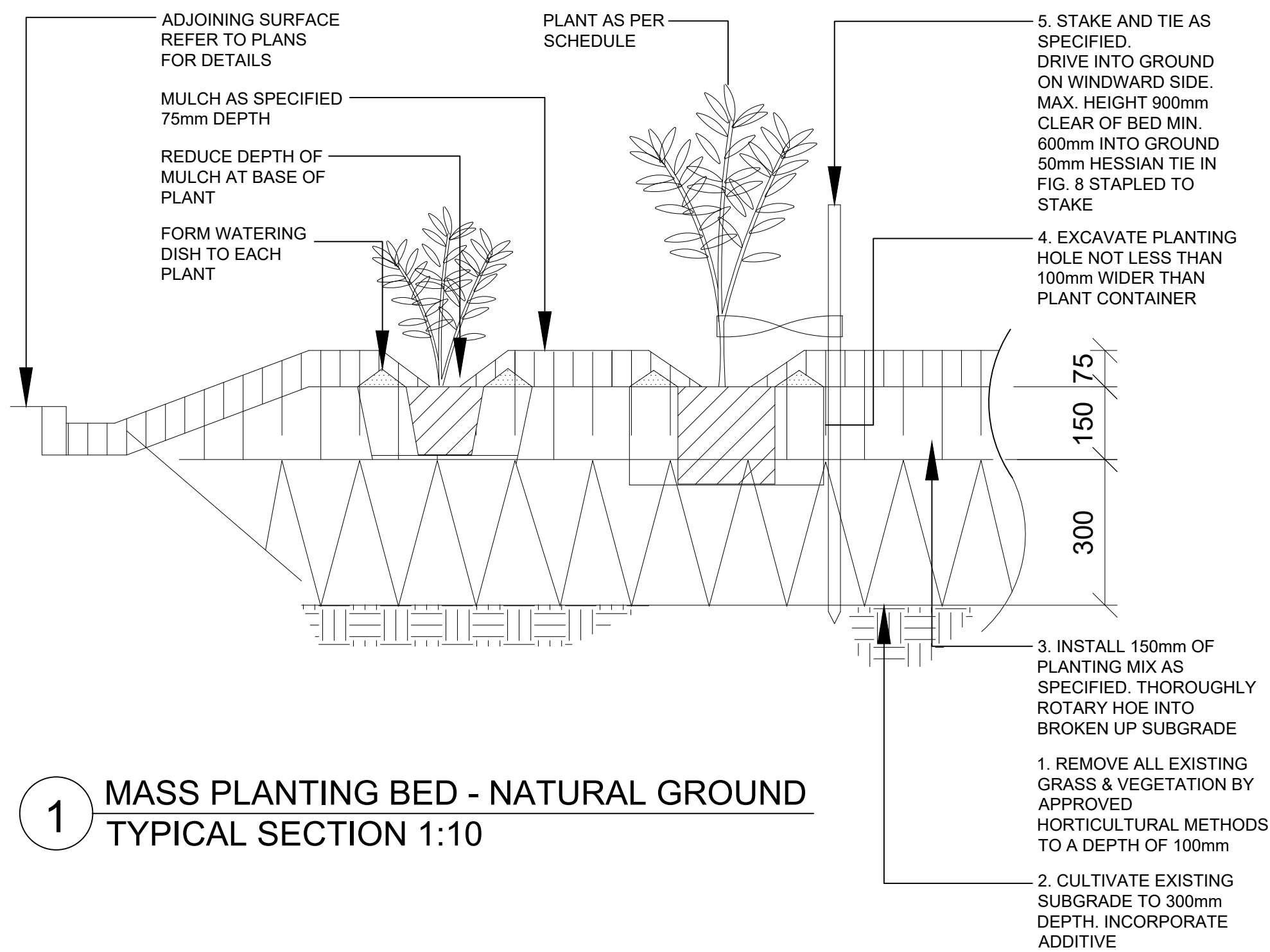

1 MASS PLANTING BED - NATURAL GROUND  
TYPICAL SECTION 1:10

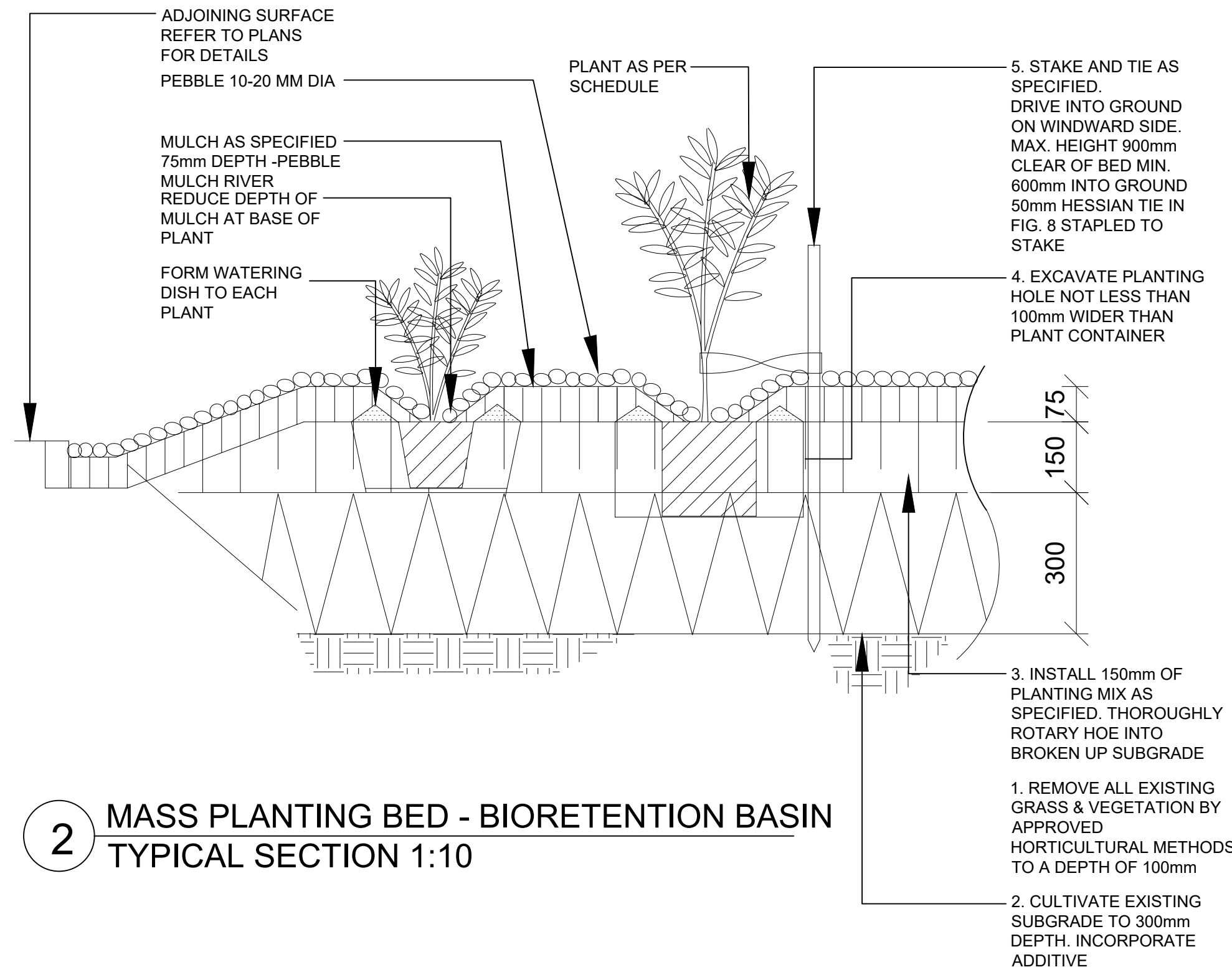

2 MASS PLANTING BED - BIORETENTION BASIN  
TYPICAL SECTION 1:10

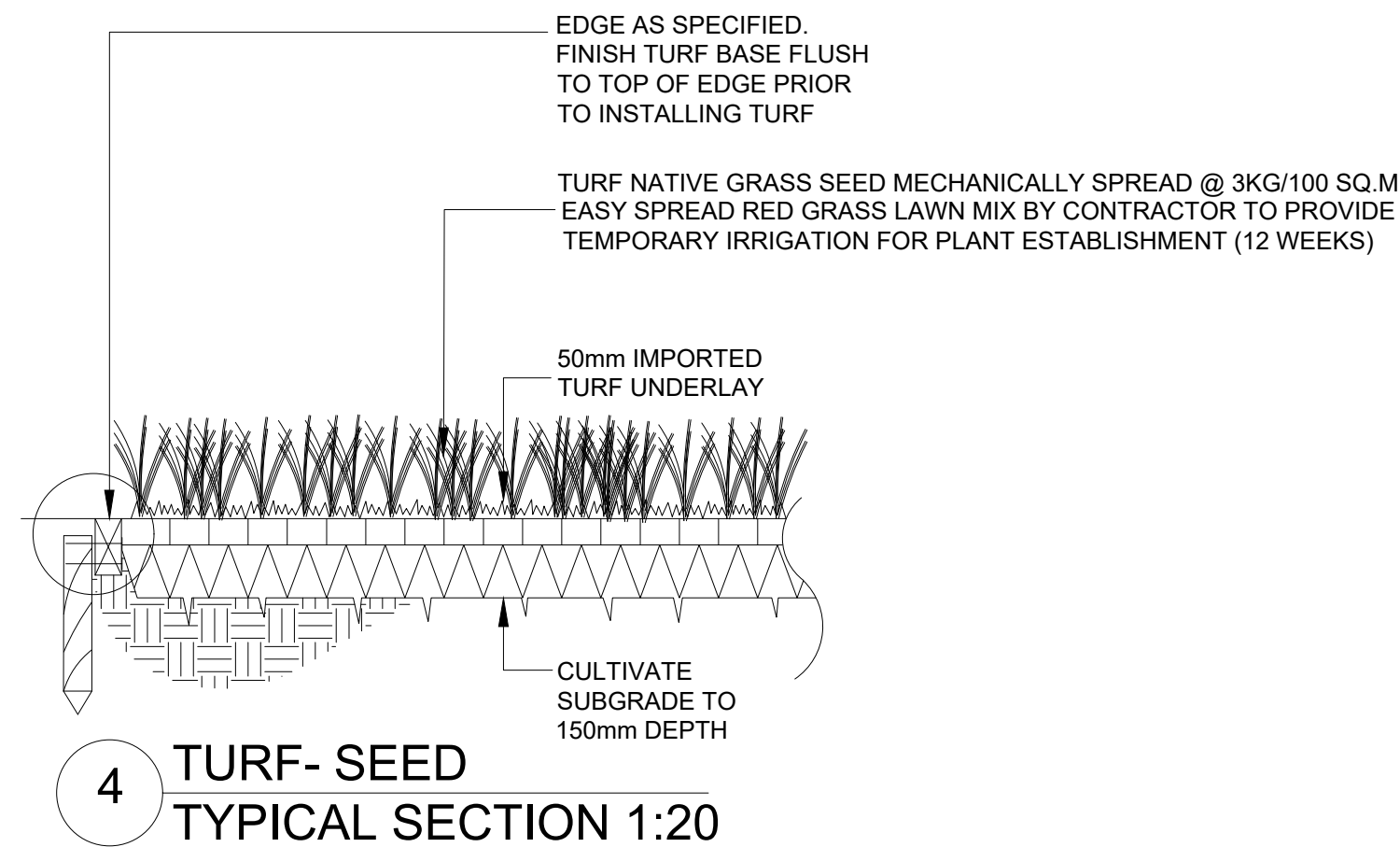

4 TURF- SEED  
TYPICAL SECTION 1:20

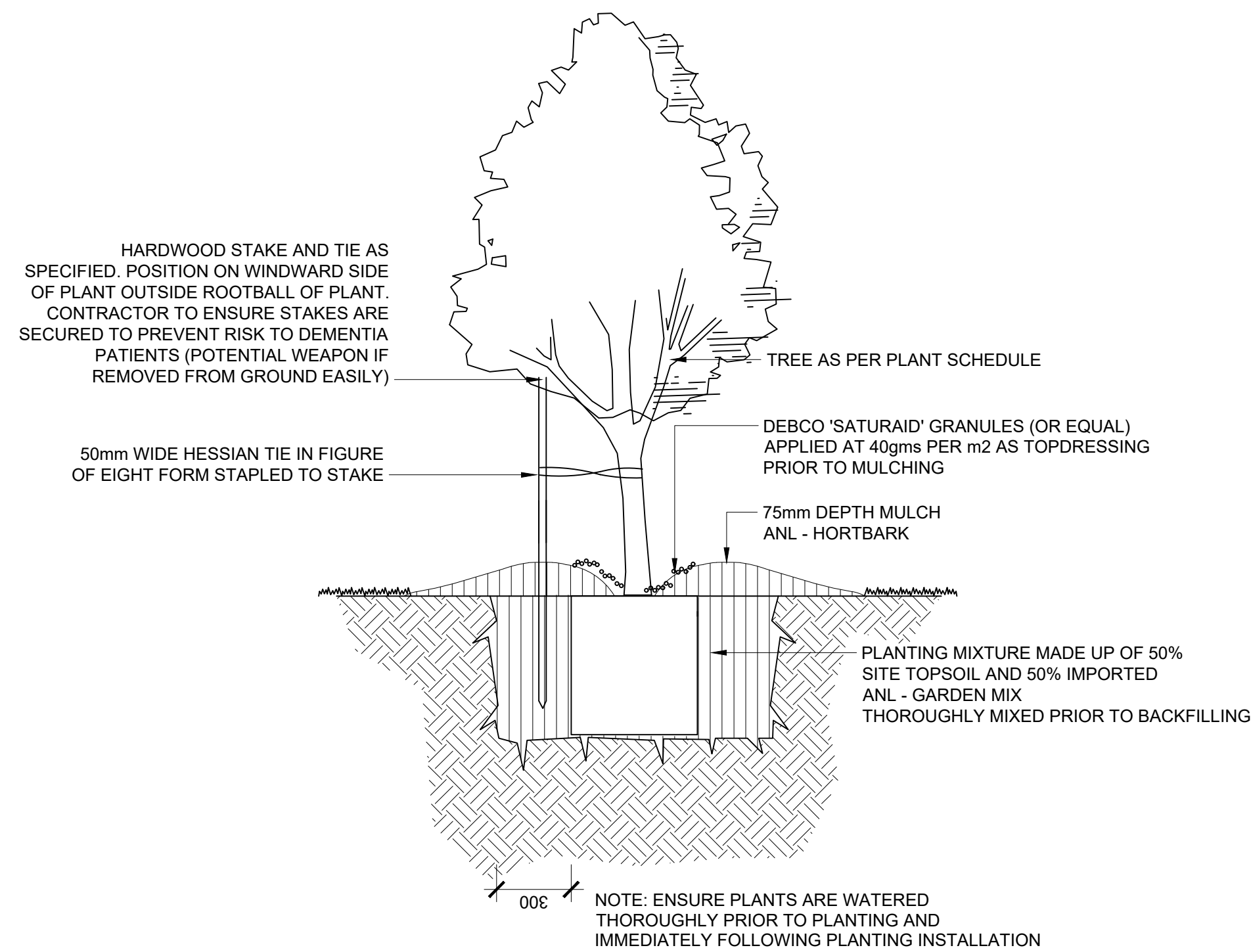

5 TREE PLANTING  
TYPICAL SECTION 1:20

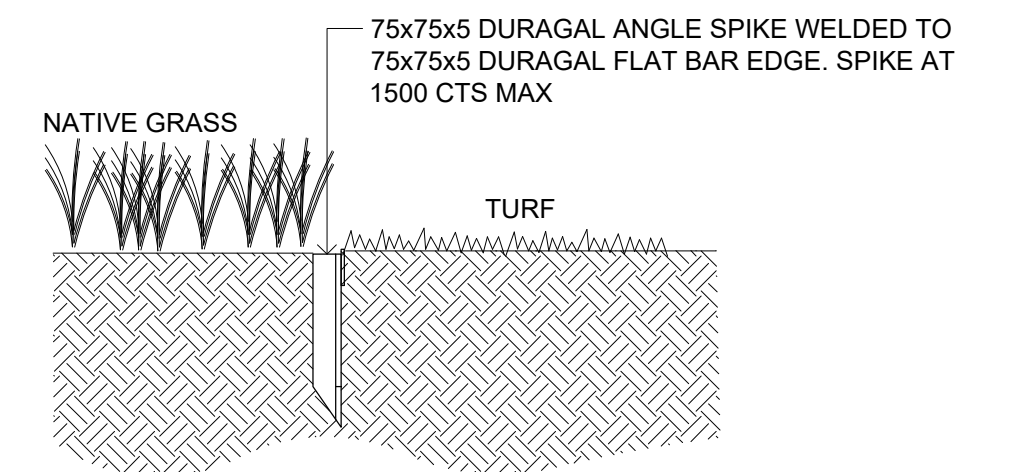

3 STEEL EDGE  
TYPICAL SECTION 1:20

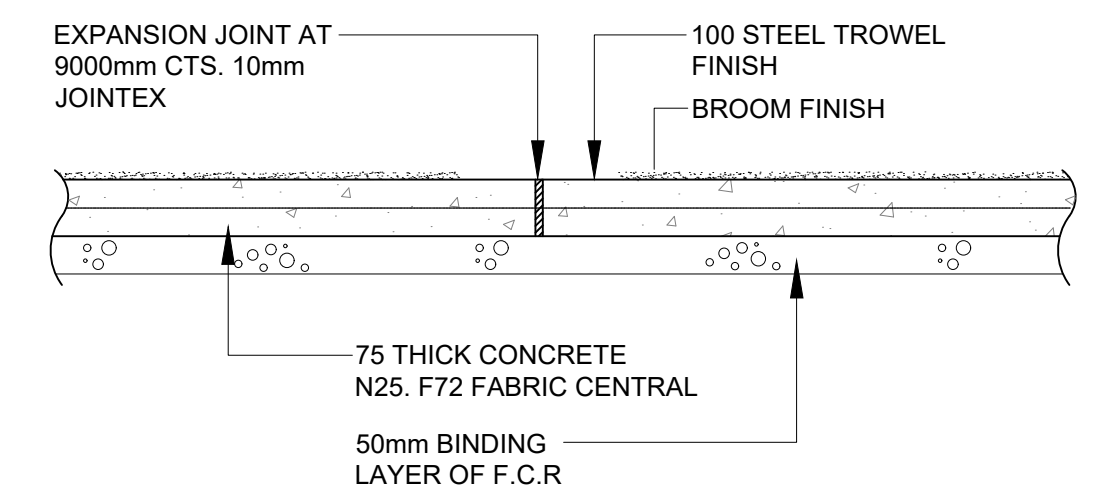

SECTION 1:10-EXPANSION JOINT

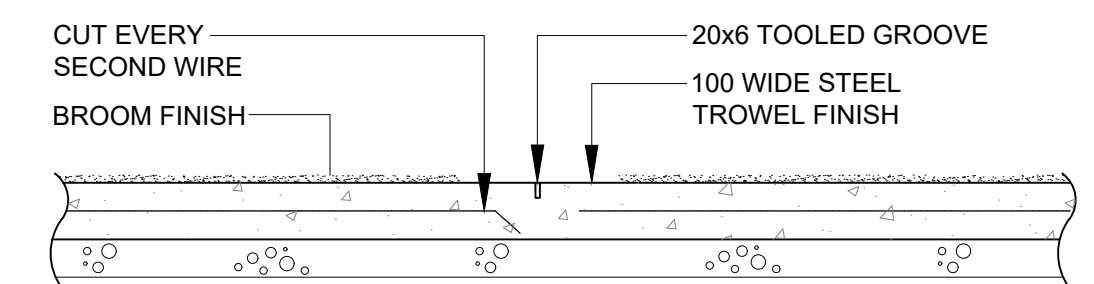

NOTE: REFER TO PLANS FOR WIDTHS AND LOCATION

SECTION 1:10-CONSTRUCTION JOINT

6 PAVING-CONCRETE  
TYPICAL SECTION 1:10